

2 WARD

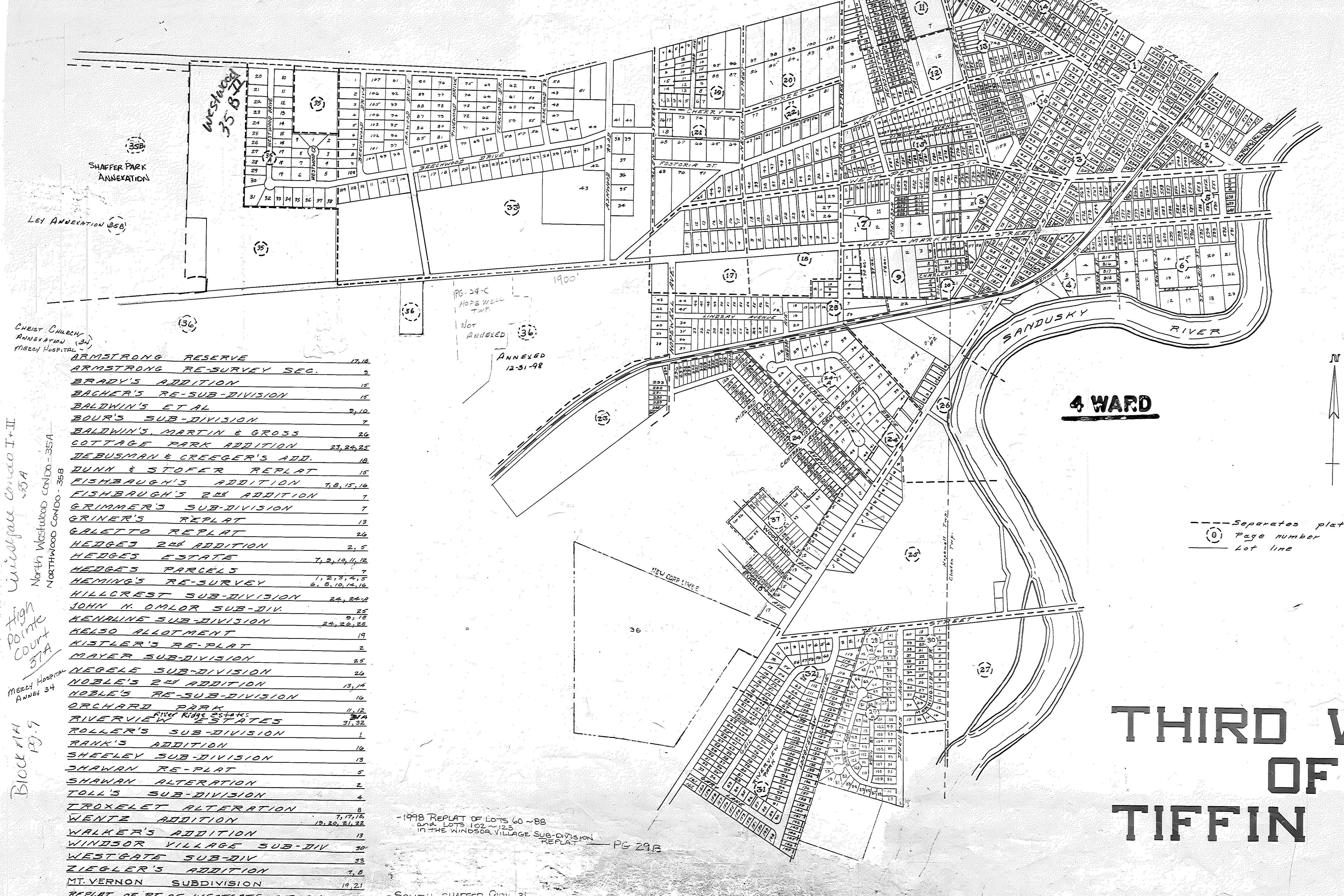

4 WARD

**THIRD WARD
OF
TIFFIN OHIO**

ARMSTRONG RESERVE	17, 18
ARMSTRONG RE-SURVEY SEC.	9
BRADY'S ADDITION	15
BACHER'S RE-SUB-DIVISION	15
BALDWIN'S ET AL	2, 10
BOUR'S SUB-DIVISION	7
BALDWIN'S, MARTIN & GROSS	26
COTTAGE PARK ADDITION	23, 24, 25
DEBUSMAN & CREEGER'S ADD.	18
DUNN & STOFER REPLAT	15
FISHBAUGH'S ADDITION	7, 8, 15, 16
FISHBAUGH'S 2ND ADDITION	7
GRIMMER'S SUB-DIVISION	7
GRINER'S REPLAT	13
GALETTO REPLAT	26
HEDGES 2ND ADDITION	2, 5
HEDGES ESTATE	7, 9, 10, 11, 12
HEDGES PARCELS	7
HEMING'S RE-SURVEY	1, 2, 3, 4, 5 6, 8, 10, 12, 16
HILLCREST SUB-DIVISION	24, 24-1/2
JOHN N. OMLOR SUB-DIV.	25
KENALINE SUB-DIVISION	9, 10
KELSO ALLOTMENT	22, 26, 28
KISTLER'S RE-PLAT	19
MAYER SUB-DIVISION	2
MEYER SUB-DIVISION	25
NEGELE SUB-DIVISION	26
NOBLE'S 2ND ADDITION	13, 14
NOBLE'S RE-SUB-DIVISION	16
ORCHARD PARK	11, 12
RIVER RIDGE ESTATES	37A
RIVERVIEW ESTATES	31, 32
ROLLER'S SUB-DIVISION	1
RANK'S ADDITION	16
SHEELEY SUB-DIVISION	13
SHAWAN RE-PLAT	5
SHAWAN ALTERATION	2
TOLL'S SUB-DIVISION	4
TROXELET ALTERATION	8
WENTZ ADDITION	7, 11, 14 19, 20, 21, 22
WALKER'S ADDITION	13
WINDSOR VILLAGE SUB-DIV	30
WESTGATE SUB-DIV	33
ZIEGLER'S ADDITION	7, 8
MT. VERNON SUBDIVISION	19, 21
REPLAT OF PT. OF WESTGATE SUB-DIV	33
CITY FARMS ALLOTMENT BLOCK 91	26
COTTAGE PARK ADD. LOTS: 38-67, 69-72	27
TOWN OF NEW FORT BARR	8
WINDSOR VILLAGE REPLAT	27, 27A
WESTWOOD VILLAGE SUBDIV.	35-9
WALKER'S ADD. REPLAT OF LOTS 792-795	13

Windsor Village Condo I+II
35A
North Westwood Condo - 35A
NORTHWOOD CONDO - 35B

High Pointe Court
37A
Mercy Hospital Annex 34

Block #1A
13.9

Westwood Sub II
35B

-1998 REPLAT OF LOTS 60-88
AND LOTS 102-123
IN THE WINDSOR VILLAGE SUB-DIVISION
REPLAT - PG 29B

SOUTH SHAFFER PARK-3L
SHAFFER PARK ANNEXATION - PG 35A
ANNEXED LAND 1943 46/36

--- Separates plat-pages
⑨ Page number
— Lot line