

- PLAT VOL./PAGE
- WALKER'S ADDITION — I 3/27
 - STANLEY'S REPLAT — II 3/54
 - SHEELY'S REPLAT — III 1/27
 - J.F. BUNN'S SUB-DIV. — IV 2/34
 - BREWER ET AL BY LAND APPR. — V 2/24
 - BLAUSIUS ET AL BY LAND APPR. — VI 3/36
 - REPLAT 1890 BY APPR. — VII 3/26
 - LEISTER'S SUB-DIV. — VIII 1/10
 - MILL RACE SUB-DIV. — IX 2/18
 - HEDGES' ESTATE 2ND ADD. — X
 - HARTER & SLOWMAN ALTERATION — XI

— LOT BOUNDARY LINE
 - - - LOT DIVISION LINE
 = = = SEPARATES DIFFERENT SUB-DIV.

SCALE: 1" = 100'

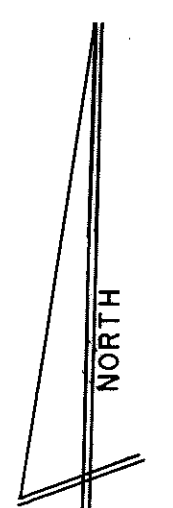

CITY OF TIFFIN SEC P6.10

SUB-DIV OF LOTS 724, 725, 726, 727, 728, 729, 730, 731, 732, 733, 734, 735, 736, 737, 738, 739, 740, 741, 742, 743, 744, 745, 746, 747, 748, 749, 750, 751, 752, 753, 754, 755, 756, 757, 758, 759, 760, 761, 762, 763, 764, 765, 766, 767, 768, 769, 770, 771, 772, 773, 774, 775, 776, 777, 778, 779, 780, 781, 782, 783, 784, 785, 786, 787, 788, 789, 790, 791, 792, 793, 794, 795, 796, 797, 798, 799, 800, 801, 802, 803, 804, 805, 806, 807, 808, 809, 810, 811, 812, 813, 814, 815, 816, 817, 818, 819, 820, 821, 822, 823, 824, 825, 826, 827, 828, 829, 830, 831, 832, 833, 834, 835, 836, 837, 838, 839, 840, 841, 842, 843, 844, 845, 846, 847, 848, 849, 850, 851, 852, 853, 854, 855, 856, 857, 858, 859, 860, 861, 862, 863, 864, 865, 866, 867, 868, 869, 870, 871, 872, 873, 874, 875, 876, 877, 878, 879, 880, 881, 882, 883, 884, 885, 886, 887, 888, 889, 890, 891, 892, 893, 894, 895, 896, 897, 898, 899, 900, 901, 902, 903, 904, 905, 906, 907, 908, 909, 910, 911, 912, 913, 914, 915, 916, 917, 918, 919, 920, 921, 922, 923, 924, 925, 926, 927, 928, 929, 930, 931, 932, 933, 934, 935, 936, 937, 938, 939, 940, 941, 942, 943, 944, 945, 946, 947, 948, 949, 950, 951, 952, 953, 954, 955, 956, 957, 958, 959, 960, 961, 962, 963, 964, 965, 966, 967, 968, 969, 970, 971, 972, 973, 974, 975, 976, 977, 978, 979, 980, 981, 982, 983, 984, 985, 986, 987, 988, 989, 990, 991, 992, 993, 994, 995, 996, 997, 998, 999, 1000